

UP03 - PIVOT Series  
3/8" Air-operated double diaphragm pump



TECHNICAL DATA

PRESSURE RATIO	1:1
MAXIMUM FREE DELIVERY	31 l/min (8.2 US gal/min)
AIR PRESSURE OPERATING RANGE	1,5 to 7 bar (20 to 100 psi)
MAX. SIZE SOLIDS IN SUSPENSION	1,6 mm (1/16")
MAXIMUM DRY SUCTION LIFT	3 m (10')
MAXIMUM WET SUCTION LIFT	7 m (23')
DISPLACEMENT PER CYCLE*	0,08 l (0,02 gal)
FLUID INLET AND OUTLET CONNECTIONS (MULTIPORTS)	3/8" NPT (F) Threaded / 3/8" BSP (F) Threaded
AIR INLET CONNECTION	1/4" NPSM (F)
AIR EXHAUST CONNECTION	1/2" NPT (F)
SOUND LEVEL	75 dB (A) @ 50 cycles/min @ 5 bar
WEIGHT: POLYPROPYLENE	1,8 kg (4 lb)
PVDF	2,3 kg (5.1 lb)
CONDUCTIVE ACETAL	2,1 kg (4.6 lb)

\* Delivery per cycle depends on the diaphragms material, air inlet pressure and fluid viscosity.

DIMENSIONS

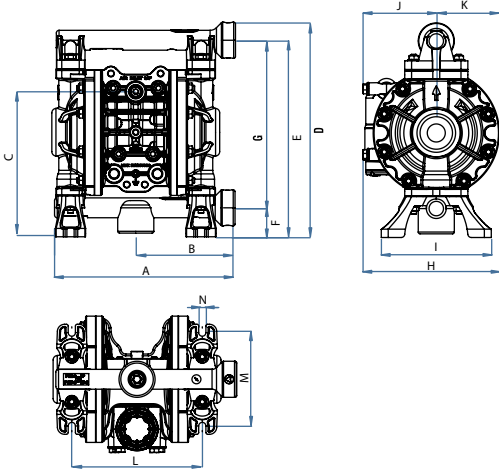

DIMENSIONS (mm)	A	B	C	D	E	F	G	H	I	J	K	L	M	N
UP03 PUMP	202	110	161	237	217	32	185	151	122	81	70	145	104	8
DIMENSIONS (inches)	A	B	C	D	E	F	G	H	I	J	K	L	M	N
UP03 PUMP	7.95	4.33	6.34	9.33	8.54	1.26	7.28	5.95	4.80	3.19	2.76	5.71	4.09	0.32

PERFORMANCE CURVES

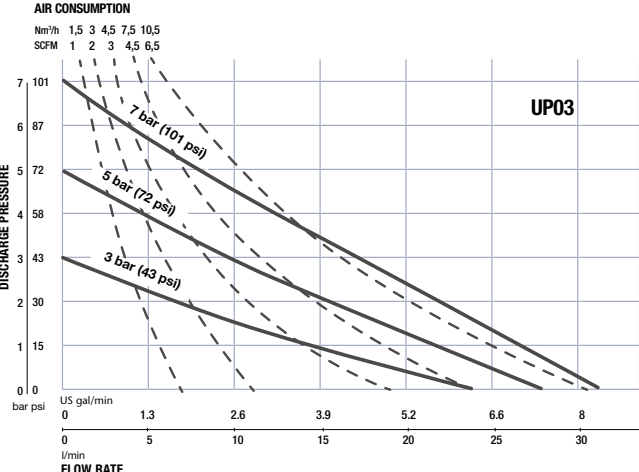

3/8"  
Air-Operated  
Double Diaphragm Pump

NON-METALLIC  
UP03

NON-METALLIC  
UP03

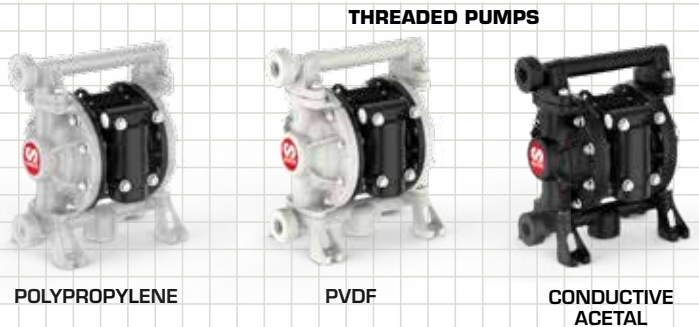

CONTACT US TODAY!  
Visit: [www.samoaindustrial.com](http://www.samoaindustrial.com) for more information.

SAMOA INDUSTRIAL, S.A. - PROCESS DIVISION  
Pol. Ind. Porceyo, I-14 • Camino del Fontán, 831  
E-33392 GIJÓN (Asturias) SPAIN  
Tel.: +34 985 381 488 - Fax: +34 985 147 213  
flow@samoaindustrial.com • www.samoaindustrial.com



© Copyright, SAMOA Industrial, S.A.  
SAMOA Industrial, S.A. es una compañía certificada ISO 9001, ISO 14001 e ISO 45001.



R-01/25 - PDF



# UP03 - PIVOT Series

## 3/8" Air-operated double diaphragm pump

31 l/min  
8.2 gal/min

The new SAMOA UP03 pump combines a Universal design with a unique frictionless Pivot-Shaft Air Valve to provide maximum performance and **energy efficiency**, exceeding market expectations.

**UP03 Non-metallic pumps make the difference through:**

- **HIGHER EFFICIENCY.** Maximum fluid flow with reduced air consumption.
- **INCREASED RELIABILITY.** No stall, no icing, reliable start-up and longer air valve and diaphragms life.
- **MAXIMUM VERSATILITY.** Polypropylene, PVDF and Conductive Acetal pumps with a wide range of diaphragms, seats and balls options offer broad fluid and application compatibility. Highly suitable for aggressive chemicals with presence of abrasives.
- **EASY SERVICING.** Simplified maintenance and cleaning. The pump is held together by carriage bolts and nuts allowing to accomplish a much faster tear down and rebuild.
- **ULTRA-COMPACT DESIGN.** Ready to meet any OEM application needs. Perfect for spraying and small dispensing applications.
- **CONNECTIVITY.** Can be configured to connect a Smart Pump-Controller System to actuate, control and monitor your pumps.

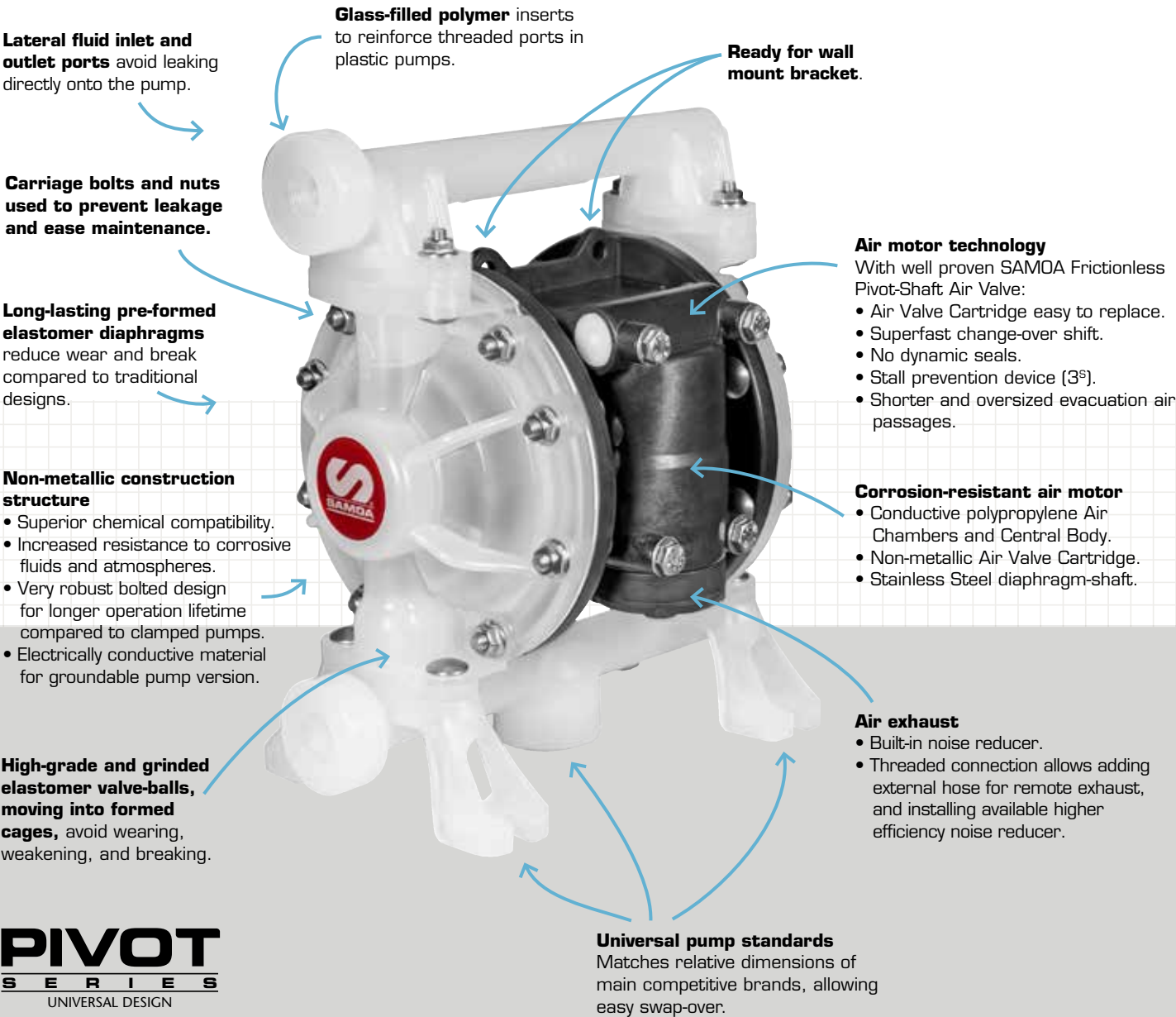

# Exclusive frictionless PIVOT-SHAFT Air Valve



**Incredibly fast changeover shift:**

- High flow delivery.
- Smooth pump operation.
- Reduced flow pulsation.
- No pump vibration.
- Reduced air consumption.

**Patented Smooth Start Shifter (3<sup>s</sup>):**

- Low-pressure start up.
- No stall operation.

**Shorter and oversized evacuation air passages:**

- No icing, even during long pump runs at high pressure.
- No whistle noise.

**Long-life Pivot-Pads (shift and evacuation)**

**Modular air valve:**

- Pivot-Shaft cartridge design
- Precision machined cartridge and Pivot-Shaft.
- Quick teardown for cleaning and repair.

**No dynamic seals:**

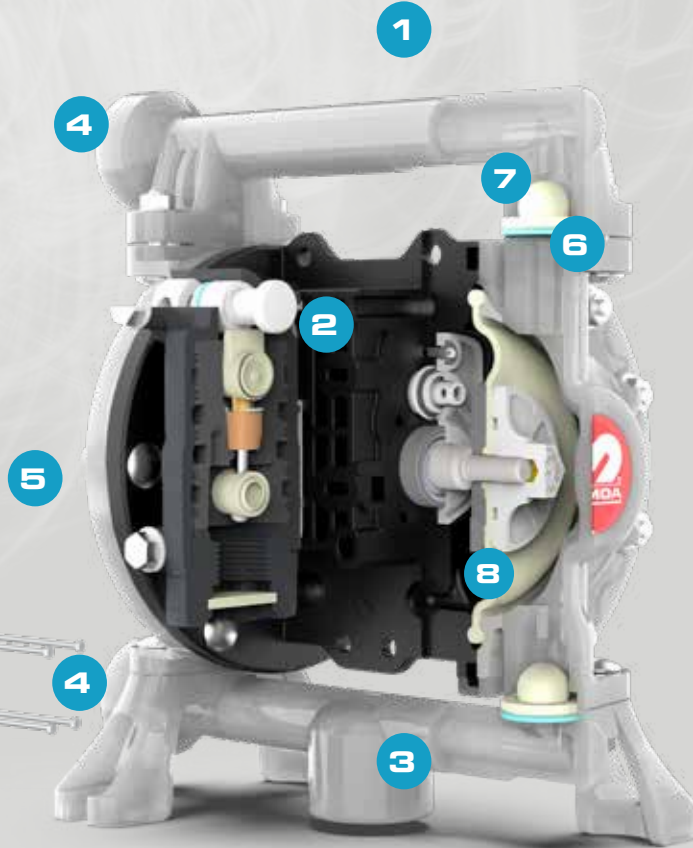

- No parts subject to wear.
- Reliably work with dry or humid air.
- No lubrication required.



# AVAILABLE MATERIALS

SAMOA offers a wide range of material options for chemical compatibility and to withstand abrasion, temperature and fatigue caused by demanding conditions.

Example: **UP03X-XXX-XXX**

UP03X		XXX			XXX		
PUMP TYPE	AIR MOTOR	HOUSINGS			WETTED PARTS		
1 Pump Type & Size	2 Central Body & Air Chambers	3 Fluid Ports / Location Multiport manifolds: central and lateral	4 Fluid Chambers & Manifolds	5 Hardware Bolts & Inserts	6 Valve Seats	7 Valve Balls	8 Diaphragms Type & Material
UP03 Universal Pump (Bolted)	 <b>ATEX Certified</b> B* = Conductive Polypropylene (black)	B = 3/8" BSP threaded ports N = 3/8" NPT threaded ports	P = Polypropylene (white) W = PVDF (Kynar®) (white)   <b>ATEX Certified</b> D* = Conductive Acetal (black)	S = Stainless Steel	C = Acetal P = Polypropylene W = PVDF	C = Acetal T = PTFE (Teflon®)	A = Santoprene® C = Hytrel® G = Nitrile (Buna-N)  Two piece Z = PTFE (Teflon with Santoprene® backer)

\*⚡ **ATEX Certified pumps** for use in hazardous locations ATEX Group II 2GDx.  
Hytrel® is a registered trademark of the DuPont Company, Viton® & Teflon® of the Chemours Company and Santoprene® of the Monsanto Company, licensed for Advanced Elastomer Systems, L.P. Kynar® is a registered trademark of Arkema, Inc.