

UP10 - PIVOT Series

1" Air-operated double diaphragm pump



TECHNICAL DATA

PRESSURE RATIO
MAXIMUM FREE DELIVERY
AIR PRESSURE OPERATING RANGE
MAX. SIZE SOLIDS IN SUSPENSION
MAXIMUM DRY SUCTION LIFT
MAXIMUM WET SUCTION LIFT
DISPLACEMENT PER CYCLE*
FLUID INLET AND OUTLET CONNECTIONS (MULTIPORTS)
AIR INLET CONNECTION
AIR EXHAUST CONNECTION
SOUND LEVEL

WEIGHT: ALUMINIUM
STAINLESS STEEL

* Delivery per cycle depends on the diaphragms material, air inlet pressure and fluid viscosity.

DIMENSIONS

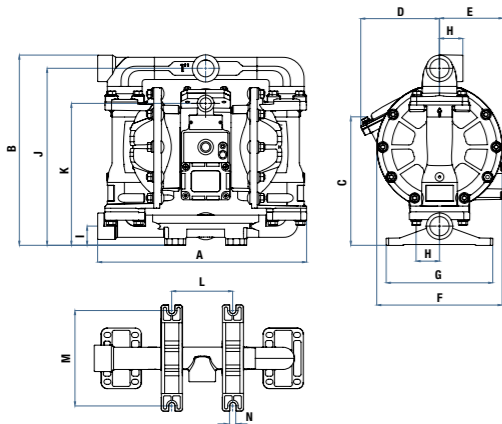

DIMENSIONS (mm)
UP10 ALUMINIUM & STAINLESS STEEL PUMP

DIMENSIONS (inches)
UP10 ALUMINIUM & STAINLESS STEEL PUMP

A	B	C	D	E	F	G	H	I	J	K	L	M	N
348	317	214	131	106	209	177	39	32	295	237	102	159	10
A	B	C	D	E	F	G	H	I	J	K	L	M	N
13.70	12.48	8.43	5.16	4.17	8.23	6.97	1.54	1.26	11.61	9.33	4.02	6.26	0.39

METALLIC UP10 - PIVOT SERIES

1:1
200 l/min (53 US gal/min)
1,5 to 8 bar (20 to 120 psi)
6,4 mm (1/4")
5 m (16')
8 m (26')
0,85 l (0,2gal)
1" NPT (F) - Threaded / 1" BSP (F) - Threaded
1/2" NPT (F)
1" NPT (F)
75 dB (A) @ 50 cycles/min @ 5 bar
Threaded
11,5 kg (25 lb)
17,5 kg (38.6 lb)

PERFORMANCE CURVES

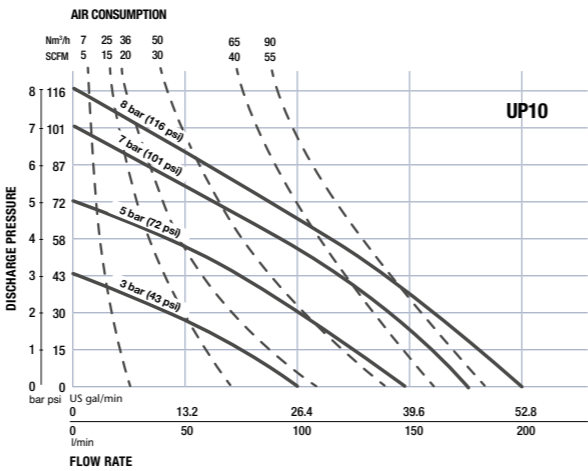

THREADED PUMPS



ALUMINIUM



STAINLESS STEEL



CONTACT US TODAY!
Visit: www.samoaindustrial.com for more information.

SAMOA INDUSTRIAL, S.A. - PROCESS DIVISION
Pol. Ind. Porceyo, I-14 • Camino del Fontán, 831
E-33392 GIJÓN (Asturias) SPAIN
Tel.: +34 985 381 488 - Fax: +34 985 147 213
flow@samoaindustrial.com • www.samoaindustrial.com



© Copyright, SAMOA Industrial, S.A.
SAMOA Industrial, S.A. es una compañía certificada ISO 9001, ISO 14001 e ISO 45001.



1"
Air-Operated
Double Diaphragm Pump

METALLIC
UP10

UP10 - PIVOT Series

1" Air-operated double diaphragm pump

200 l/min
53 gal/min

The new SAMOA UP10 pump combines a Universal design with a unique frictionless Pivot-Shaft Air Valve to provide maximum performance and **energy efficiency**, exceeding market expectations.

UP10 Metallic pumps make the difference through:

- **HIGHER EFFICIENCY.** Maximum fluid flow with reduced air consumption.
- **INCREASED RELIABILITY.** No stall, no icing, reliable start-up and longer air valve and diaphragms life.
- **MAXIMUM VERSATILITY.** Aluminium and Stainless Steel pumps with a wide range of diaphragms, seats and balls options offer broad fluid and application compatibility. Highly suitable for outdoors and general applications with presence of abrasives.
- **EASY SERVICING.** Simplified maintenance and cleaning. The pump is held together by carriage bolts and nuts allowing to accomplish a much faster tear down and rebuild.
- **COMPACT DESIGN.**
- **CONNECTIVITY.** Can be configured to connect a Smart Pump-Controller System to actuate, control and monitor your pumps.

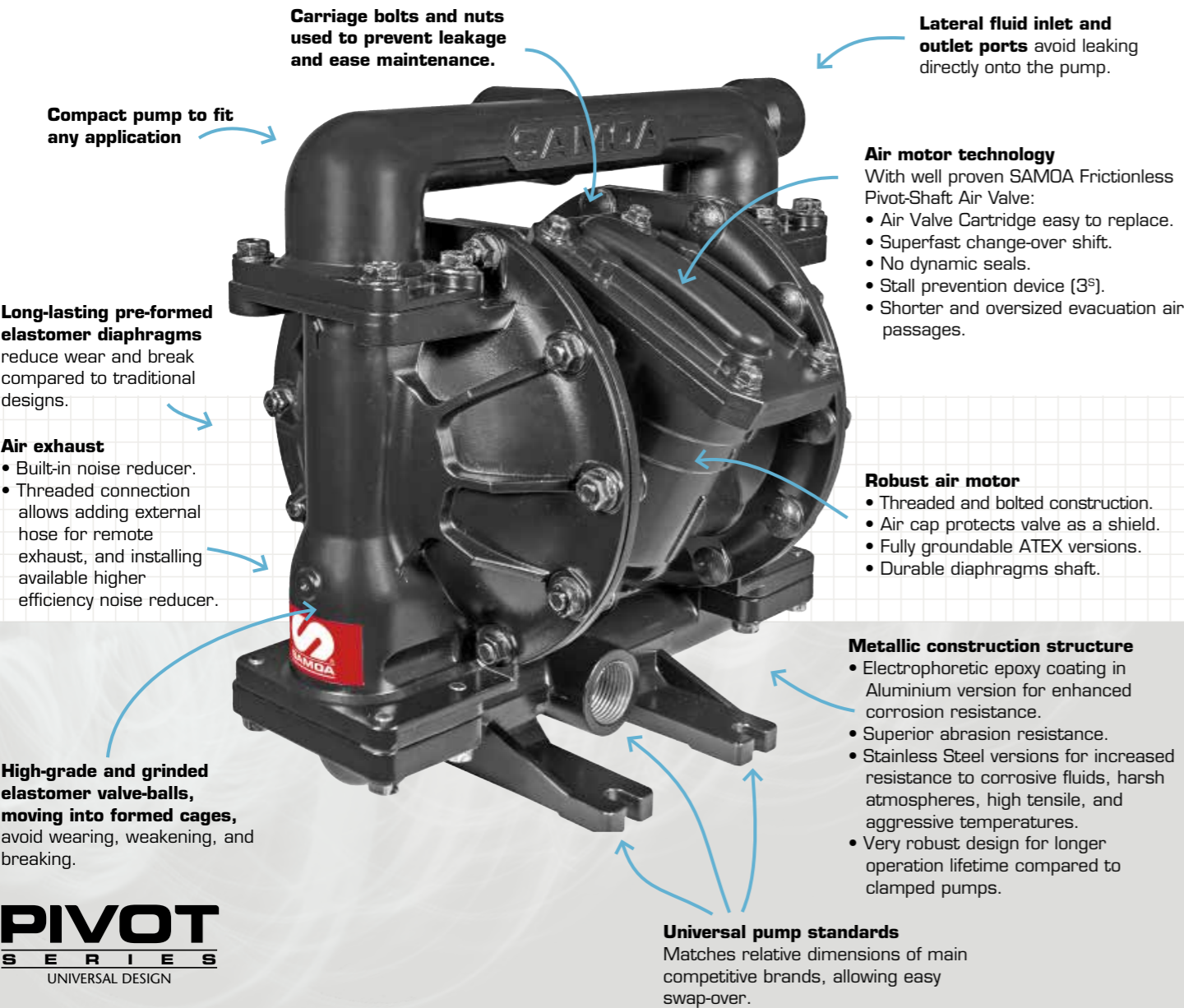

Exclusive frictionless PIVOT-SHAFT Air Valve

3^s
Smooth-Start-Shifter

Patented®

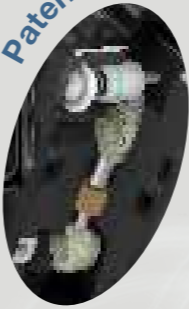

Incredibly fast changeover shift:

- High flow delivery.
- Smooth pump operation.
- Reduced flow pulsation.
- No pump vibration.
- Reduced air consumption.

Patented Smooth Start Shifter (3^s):

- Low-pressure start up.
- No stall operation.

Shorter and oversized evacuation air passages:

- No icing, even during long pump runs at high pressure.
- No whistle noise.

Long-life Pivot-Pads (shift and evacuation)

Modular air valve:

- Pivot-Shaft cartridge design
- Precision machined cartridge and Pivot-Shaft.
- Quick teardown for cleaning and repair.

No dynamic seals:

- No parts subject to wear.
- Reliably work with dry or humid air.
- No lubrication required.

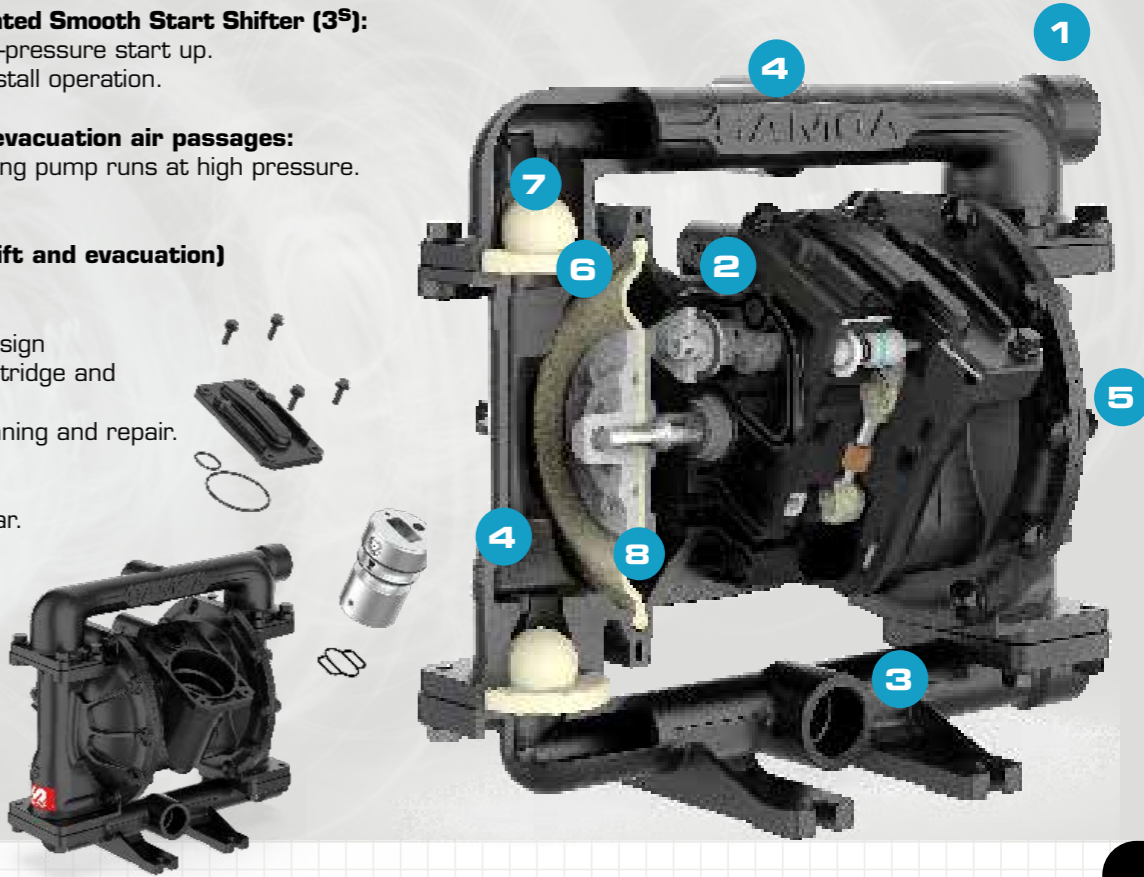

AVAILABLE MATERIALS

SAMOA offers a wide range of material options for chemical compatibility and to withstand abrasion, temperature and fatigue caused by demanding conditions.

Example: **UP10X-XXX-XXX**

UP10X		XXX			XXX		
PUMP TYPE	AIR MOTOR	HOUSINGS			WETTED PARTS		
1 Pump Type & Size	2 Central Body & Air Chambers	3 Fluid Ports / Location Multiport manifolds: central and lateral	4 Fluid Chambers & Manifolds	5 Hardware Bolts & Inserts	6 Valve Seats	7 Valve Balls	8 Diaphragms Type & Material
UP10 Universal Pump (Bolted)	ATEX Certified A* = Aluminium B* = Conductive Polypropylene (only for pumps with Stainless Steel Fluid Chambers & Manifolds)	B = 1" BSP threaded ports N = 1" NPT threaded ports	ATEX Certified A* = Aluminium S* = AISI 316 Stainless Steel	C = Carbon Steel S = Stainless Steel	A = Aluminium H = Hytrel® M = Santoprene® N = Nitrile (Buna-N) T = PTFE (Teflon®) S = AISI 316 Stainless Steel	H = Hytrel® M = Santoprene® N = Nitrile (Buna-N) T = PTFE (Teflon®) S = AISI 316 Stainless Steel V = FKM (Viton®)	A = Santoprene® C = Hytrel® G = Nitrile (Buna-N) V = FKM (Viton®) Two piece Z = PTFE (Teflon with Santoprene® backer)

* **ATEX Certified pumps** for use in hazardous locations ATEX Group II 2GDx.

Hytrel® is a registered trademark of the DuPont Company, Viton® & Teflon® of the Chemours Company and Santoprene® of the Monsanto Company, licensed for Advanced Elastomer Systems, L.P. Kynar® is a registered trademark of Arkema, Inc.

Contact us for more information about connected pumps' configuration.

NO VIBRATION | PROVEN SUPERIOR PERFORMANCE | RELIABLE | DURABLE | LOWER CONSUMPTION | UNIVERSAL

Product pictures and specifications are subject to change without prior notice.

METALLIC
UP10